

A close-up photograph of a wooden workbench. In the center, a metal chisel with a wooden handle lies on the surface. To its left, a large wooden block is being worked on, with several long, thin shavings curled around it. The lighting is warm and directional, creating strong shadows and highlights on the wood's grain and the metal of the chisel. The background is dark, making the workbench and tools the focal point.

*Accuride*<sup>®</sup>

PRECISION BALL BEARING SLIDE PRODUCTS

FOR WOOD FURNITURE  
& WOOD CABINETS

SPRING 2011



# Accuride



Accuride International Inc. started as a small tool and die shop in 1962 in South Gate, California, producing top-quality slides for tape drives and copy machines.

In the late 1960s, Accuride developed ball bearing slides for metal office furniture. The company's design engineers then took on the wood furniture market, developing features such as breathing tabs to absorb tolerances in wood products.

Today, still privately held, Accuride has nearly one million square feet of manufacturing space around the world and is the largest company in the world dedicated to the innovative design and manufacturing of ball bearing slides. Accuride slides are designed into a wide range of applications from fine furniture and appliances, to electronic enclosures, and automotive and industrial equipment.

Accuride built its reputation on quality and ensures strict standards are met by maintaining control over many manufacturing processes others routinely job-out. Progressive dies, roll forms, and plating lines are designed, built, and maintained in house, as are other key tools and machinery.

The North American facilities feature the largest tooling operation in the industry. Globally, Accuride employs more than 100 tool and die makers, has 77 roll form machines and two in-house steel mills.

Accuride plates over 75,000,000 square feet of material per year and is the largest zinc plater in the world. Accuride was the first slide manufacturer to use the electro-coating process on ball bearing slides and has developed finishes that vigorously resist corrosion.

Accuride's test laboratory is among the largest in the industry. Products are tested to meet or exceed standards established by ANSI and other testing agencies.

Accuride was the first U.S. based slide manufacturer awarded ISO 9000 certification. Today, all our production facilities have quality management systems registered to ISO 9001:2008.

As a part of Accuride's global commitment to adhering to local environmental laws (even exceeding the standards, whenever practical), using raw materials efficiently, and reducing waste, all slide finishes and components comply with the Restriction of Hazardous Substances (RoHS) Directive.



## SLIDES FOR WOOD FURNITURE AND WOOD CABINETRY SPRING 2011

<b>Technical Information</b> _____	<b>2</b>
<i>Slide Selection Criteria</i>	
<b>Cross Section Guide</b> _____	<b>4</b>
<b>Light-Duty Slides</b> _____	<b>7</b>
<i>1029, 2037, 2632, 2132</i>	
<b>Medium-Duty Slides</b> _____	<b>10</b>
<i>3732, Eclipse Undermount, 7432/7434, 3017, 3832 Family, 3864,</i>	
<b>Heavy-Duty Slides</b> _____	<b>16</b>
<i>400 Series, 3641, 3640A, 7950, 7957, 9301, AL4140, AL4120</i>	
<b>Media Hardware Collection</b> _____	<b>22</b>
<i>Ascent, CB3620-258TV, Quick Lift, M.A.C. Systems</i>	
<b>Flipper Door Slides®</b> _____	<b>26</b>
<i>117, 1145, 1155, 123/1234 1321 Pro Pocket, 1332/1432</i>	
<b>Specialty Slides</b> _____	<b>31</b>
<i>2006, 2109, Keyboard Tray Systems, Stainless Steel Slides, 2019, 2002, 0363 322, 340, 301-2590, 3600-200, 3600-201</i>	
<b>Limited Lifetime Warranty</b> _____	<b>40</b>

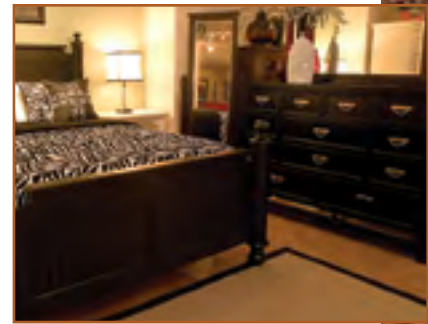

Furniture by [www.diamondcase.com](http://www.diamondcase.com)





## To the reader:

This catalog is designed to assist you in making the proper slide selection for your application. The information listed on the next two pages explains the pertinent factors to consider when selecting a slide. The products in this catalog are divided into six sections:

- ◆ **Light-Duty Slides** — Load ratings up to 75 pounds. These slides are suitable for small box drawers in residential and commercial cabinetry.
- ◆ **Medium-Duty Slides** — Load ratings range from 90–100 pounds. This group is appropriate for residential cabinetry, casework, and commercial desk and credenza drawers.
- ◆ **Heavy-Duty Slides** — Load ratings from 100–966 pounds. Suitable for a wide range of applications such as wide lateral files, large storage drawers, file cabinets, and pantry pull-outs.
- ◆ **Media Hardware Collection** — Load ratings from 14.5–300 pounds. These products offer solutions for residential and commercial applications requiring access to media and other electronic components.
- ◆ **Flipper Door Slides®** — Load ratings from 25–75 pounds. These slides carry doors for entertainment centers, overhead storage units, and armoires.
- ◆ **Specialty Slides** — Load ratings from 45–350 pounds. This group includes stainless steel products, slides for kitchen cutting boards, pencil drawers, pull-out and pass-through shelves, and keyboard trays.

Each section has a convenient selection guide, along with detailed descriptions for each product. For additional information, technical sheets, and specific design information, visit our web site at [www.accuride.com](http://www.accuride.com).

## DESIGN FACTORS

As with the selection of any system component, when choosing a slide for a specific application, you should consider the full range of features by comparing the project requirements to the key performance elements of the slide.

**Length**—Slide length is measured as the longest dimension of a fully closed slide. As a rule, always use the maximum length allowable in the application.

**Extension**—Or “travel”, refers to how far the drawer extends from the cabinet.

**3/4 extension** Drawer opens partially, about 3/4 of the total slide length.

**Full extension** Drawer opens the same amount as the slide length.

**Over travel** Drawer opens more than the length of the slide.

**Drawer Width**—In general, wider drawers require a slide with a higher load rating and a cross section designed to withstand lateral stress. Consult product technical sheet for slide recommendations based on drawer widths.

**Types of Movement**—There are generally two types of slide movement:

**Telescoping** Slide movement occurs in stages. The drawer member extends fully and then picks up the intermediate member, pulling it to the end of the travel.

**Progressive** Movement is a result of all slide members moving simultaneously. This type of movement provides extremely smooth, quiet movement.

**Disconnects**—The disconnect feature enables you to remove a drawer or drawer member for mounting or general purposes. Four types of disconnects are commonly found in slides for commercial and residential applications:

**Lever** Disconnect is achieved by releasing an internal lever and pulling the drawer straight outward, away from the cabinet.

**Rail** A rail latch allows you to raise the drawer off the slide and away from the cabinet. This type of disconnect facilitates smooth movement and easy drawer removal.

**Friction** No levers or latches are required to remove the drawer. Disconnect is achieved by pulling the drawer firmly through the resistance of the ball retainer.

**Push Latch** A latch is pressed to release the drawer. Disconnect is achieved by pulling the drawer firmly through the resistance of the ball retainer.

*Note: Disconnect instructions are available online at [www.accuride.com/woodworking/resources/disconnect](http://www.accuride.com/woodworking/resources/disconnect)*

**Slide Profiles**—More than one slide profile (or height) may be appropriate for a given application. Accuride provides several low-profile design options for applications in which a smaller profile would enhance the appearance of the completed unit.

## LOAD FACTORS

**Load Rating**—Most Accuride slides are tested a minimum of 50,000 cycles in accordance with the guidelines of all applicable ANSI/BIFMA specifications, or as appropriate for some moderate use applications. See the product technical sheet for specific information regarding test criteria. Thorough testing means that you can count on Accuride slides to meet industry-accepted criteria.

Our slides are rated for the dynamic load that an 18" pair will carry without failure (load rating decreases proportionally beyond the 18" length). In all cases, the static (resting) load capacity of each model is at least twice the load rating, providing at minimum a 100% static safety factor, even when the slide is loaded to its maximum rating. Because slide performance may be affected by factors unique to a specific application, always test slides in the intended application.

**Flat Mounting**—For optimal slide performance, mount slides only as indicated in the catalog or on the technical sheet. Certain slides may be mounted flat under a drawer, but the resulting load rating will be at least 50% less than the load rating applicable to the same pair of slides mounted vertically on the side of the drawer. Please consult the product technical sheet for specific flat-mount load rating information.

**Shock/Vibration**—Subjecting slides to shock and vibration may adversely affect the performance. Applications that are subject to these conditions should be tested to evaluate the affect on slide performance. If conditions are severe, select a heavier-duty slide.

## APPLICATION FACTORS

**Unit Construction**—When installed in a drawer or cabinet that is lightweight and flexible, drawer slides can contribute to the structural rigidity of the unit. To ensure that the slide is able to provide this support, select a model with a slightly higher load rating and larger cross section than you would ordinarily need for the application.

**Installation**—Most slides are designed to be mounted in pairs on the sides of drawers or moving unit. When installing slides, exercise care to ensure that they are mounted parallel to each other, in vertical and horizontal axes.

Before mounting slides other than as designed, carefully consider any potential adverse effects on the slide and, if necessary, consult the factory. For example, mounting slides flat under the drawer, rather than on the side, will lower the load rating by at least 50%, but mounting a slide high on one side and low on the other side will have little adverse effect on load rating. Be sure to evaluate the mounting scheme thoroughly and test as needed. Not all slide models can be used in flat-mount applications.

## ENVIRONMENTAL FACTORS

Unless otherwise stated, Accuride slides are designed for indoor use and should be protected from excessive moisture, chemical fumes, dirt, and corrosion. The Accuride self-cleaning ball retainer protects slide raceways by removing foreign particles between ball bearings, and the lubricant provided is sufficient for normal slide life. Use care when applying finishing agents because the overspray may affect slide movement. Should you need to clean the slides, you can re-lubricate them with a quality grease rated “EP” for extreme pressure.

Extreme temperatures can also affect the lubricant and plastic or rubber components. Commercial drawer slides are designed to be used for extended periods in temperatures between 0 and 180 degrees Fahrenheit. For service outside normal temperature and humidity ranges, consult the factory.

## TECHNICAL SUPPORT

Please visit the *Technical Resources* section on our web site at [www.accuride.com](http://www.accuride.com) for the most current technical information.

For further assistance, use the online *Technical Support Request* or send an e-mail to [technical@accuride.com](mailto:technical@accuride.com).

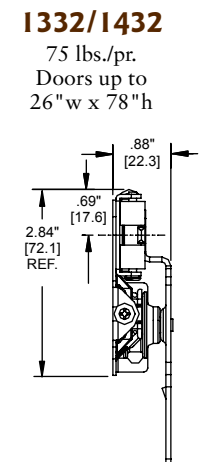
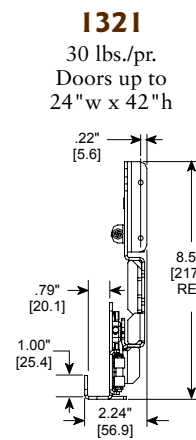
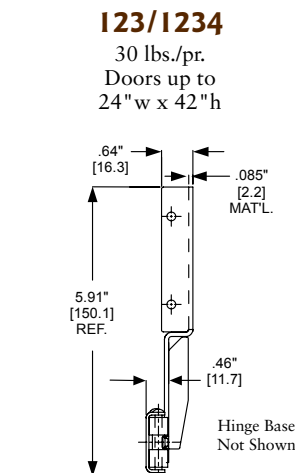
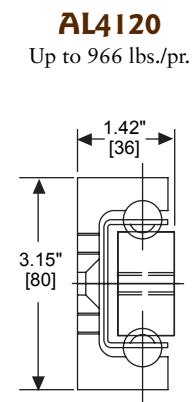
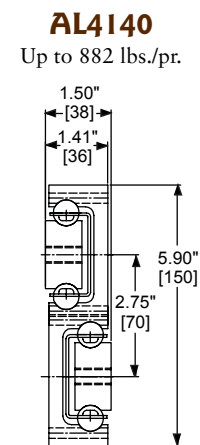
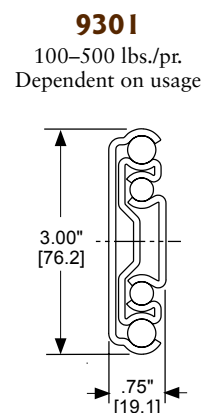
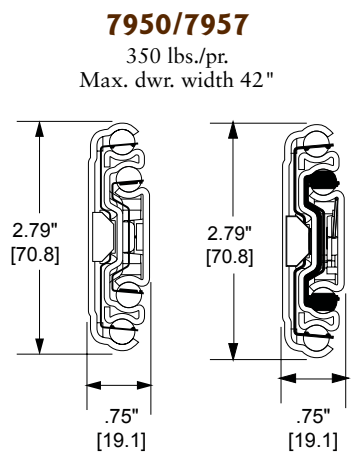
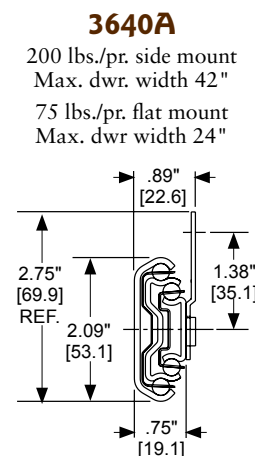
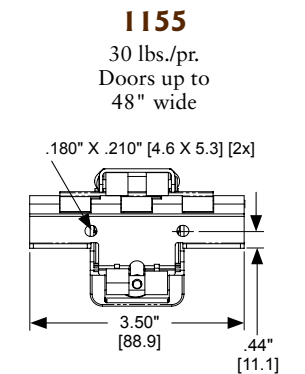
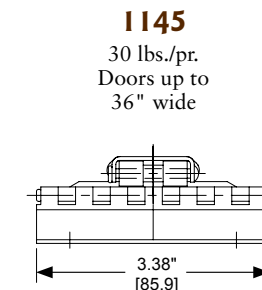
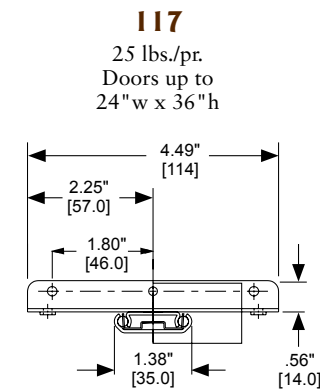
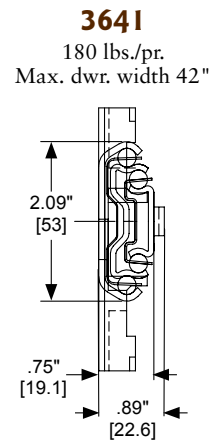
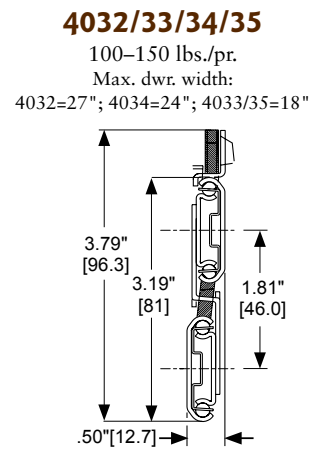
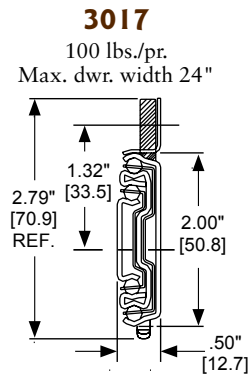
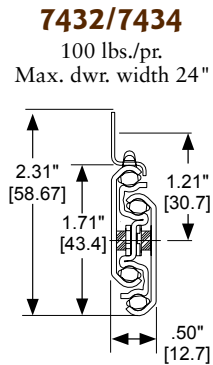
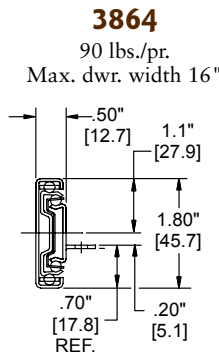
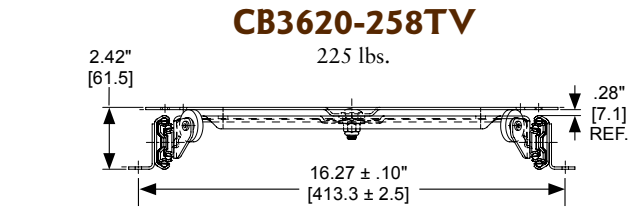
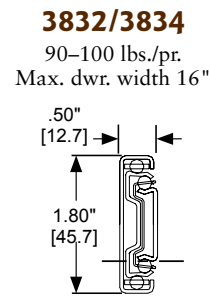
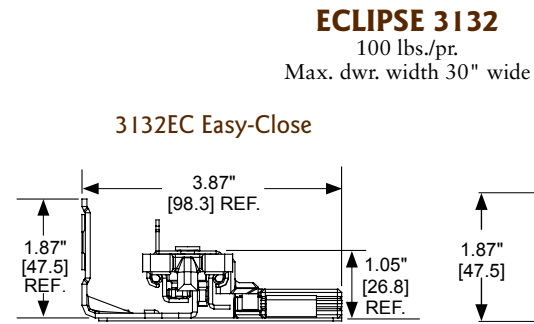
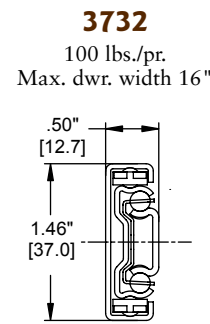
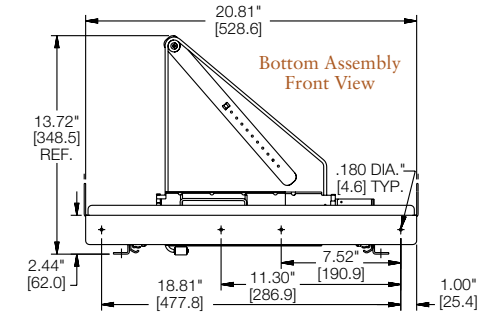
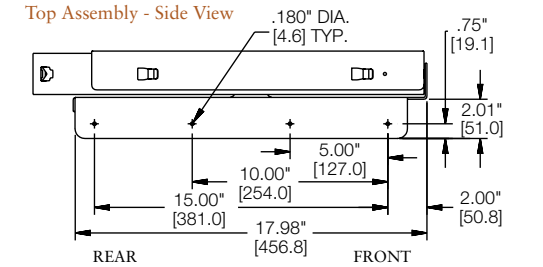
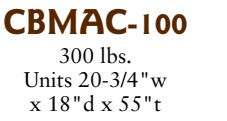
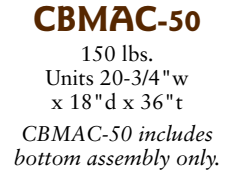
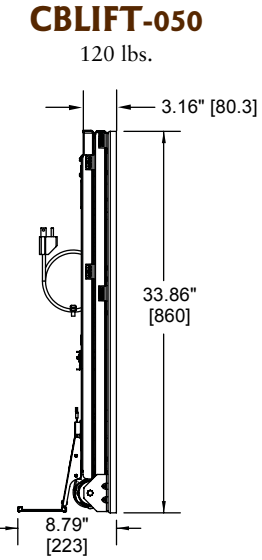
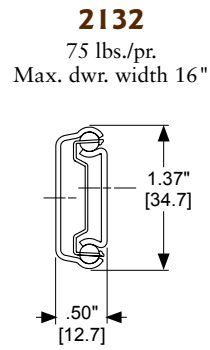
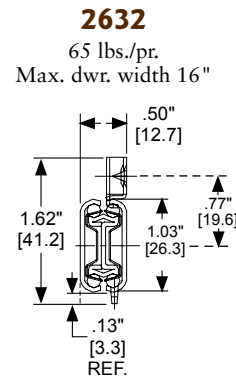
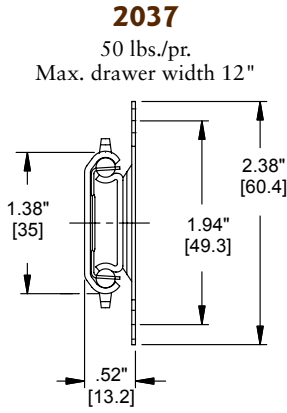
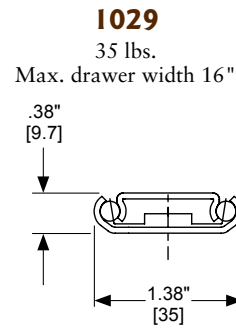



**2006**  
45 lbs./pr.  
Max. dwr. width 16"

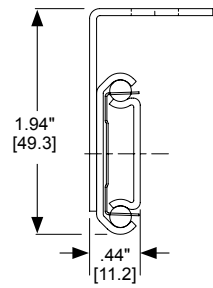

**2109**  
75 lbs./pr.  
Max. dwr. width 16"

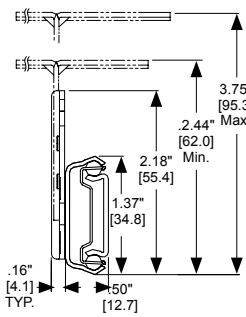

**2019**  
75 lbs./pr.  
Max. dwr. width 16"

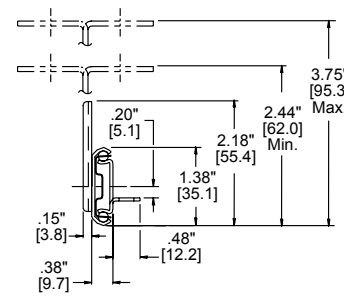

**2002**  
50 lbs./pr.  
Max. dwr. width 12"

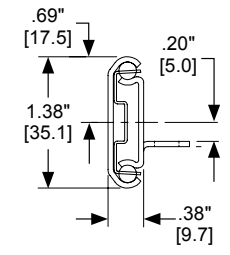

**SS2028**  
100 lbs./pr.  
Max. drawer width 18"

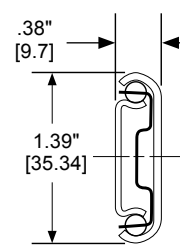

**SS0330**  
143 lbs./pr.  
Max. drawer width 18"

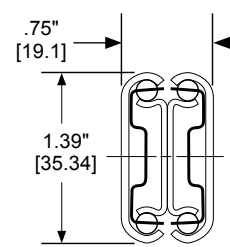

**SS5321**  
350 lbs./pr.  
Max. drawer width 18"

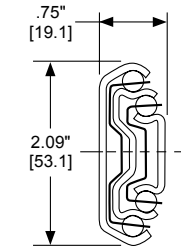

**SS5322**  
265 lbs./pr.  
Max. drawer width 18"

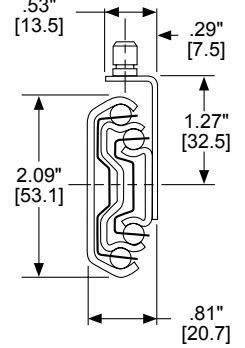

**CBBERGO-TRAY200/300**  
Profile width 29.6"

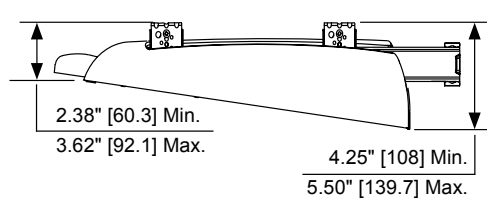

**0363**  
100 lbs./pr.  
Max. dwr. width 18"

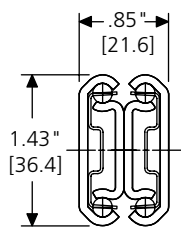

**322**  
100 lbs./pr.  
Max. dwr. width 16"

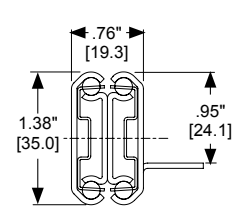

**340**  
110 lbs./pr.  
Max. dwr. width 18"

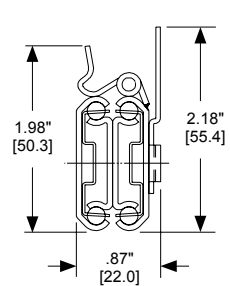

**301-2590**  
130 lbs./pr.  
Max. dwr. width 16"

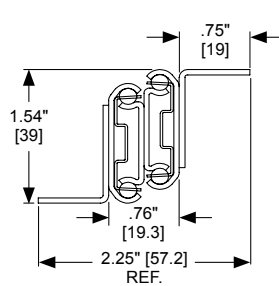

**3600-200**  
175 lbs./pr.  
Max. dwr. width 16"

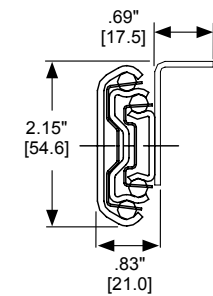

**3600-201**  
175 lbs./pr.  
Max. drawer width 16"

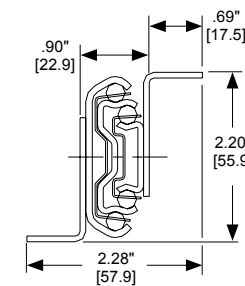

35-75 POUNDS  
DRAWER WIDTHS 12-16 INCHES

MODEL	LOAD RATING	TRAVEL	DRAWER WIDTH	DETENT	DISCONNECT	PAGE
1029	35 lbs. [16 kg]	3/4	16" [406 mm]	None	Friction	8
2037	50 lbs. [23 kg]	3/4	12" [305 mm]	None	Rail	8
2632	65 lbs. [30 kg]	Full	16" [406 mm]	Hold-in	Rail	9
2132	75 lbs. [34 kg]	3/4	16" [406 mm]	Hold-in	Lever	9



# 1029

35-lb. [16 kg] load rating

A concealed undermount slide for small shallow drawers in light-duty applications

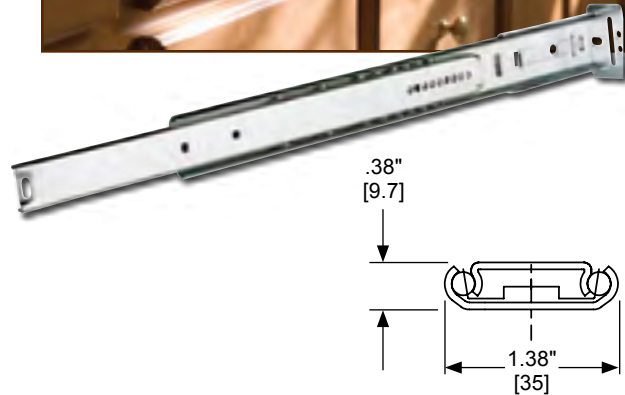

### SPECIFICATIONS

- 3/4 extension
- Drawers up to 16" [406 mm] wide
- Friction disconnect
- Steel ball bearings
- Lengths 13"-27" [330-685 mm]
- Clear zinc or black finish

### SPECIAL FEATURES

- Single slide concealed under drawer
- Eliminates side space requirements

Adjustable rear mounting bracket:  
P/N 4010-0157-CE

Reversed rear mounting bracket:  
P/N 4010-0353-CE

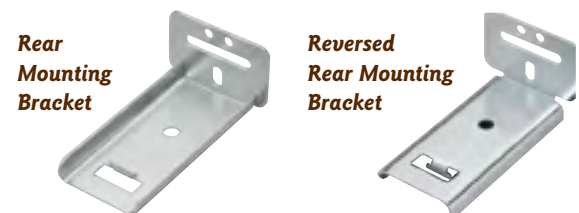

# 2037

50-lb. [23 kg] load rating

Light-duty kitchen, bath, desk, or box drawers where premium movement is required in 3/4 extension.

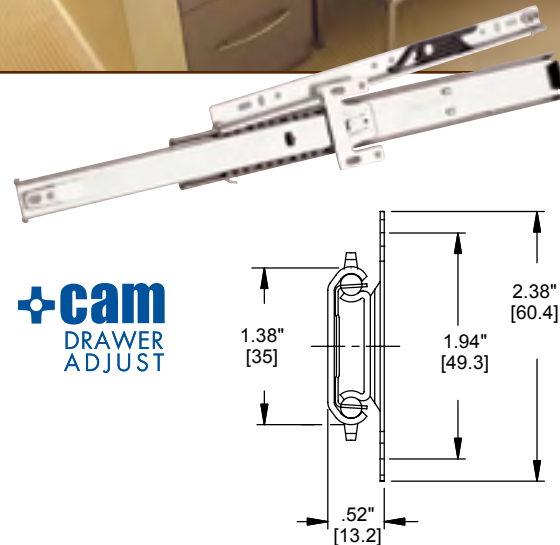

### SPECIFICATIONS

- 3/4 extension
- .52" [13.2 mm] side space
- Drawers up to 12" [305 mm] wide
- Cam Drawer Adjust
- Rail mount/disconnect
- Polymer ball bearings
- Even lengths 12"-28" [302-705 mm]
- Clear zinc or black finish

# 2632

65-lb. [30 kg] load rating

Suitable for light-duty commercial or residential use; from store fixtures to lab furniture to kitchen box drawers.

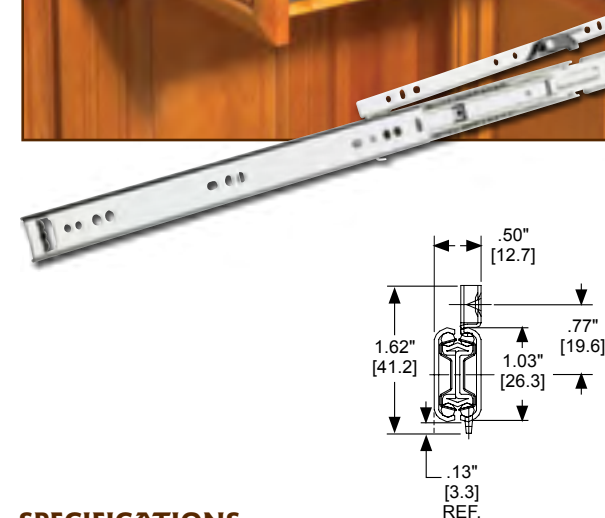

### SPECIFICATIONS

- Full extension
- .50" [12.7 mm] side space
- Drawers up to 16" [406 mm] wide
- Rail mount/disconnect
- Steel ball bearings
- Even lengths 8"-22" [203-559 mm]
- Clear zinc or black finish

### SPECIAL FEATURES

- Lowest profile rail mount
- Hold-in detent to prevent drawer roll-out and bounce-back
- Silenced in and out
- 32 mm and traditional hole pattern

# 2132

75-lb. [34 kg] load rating

Use in small shallow drawers intended for office supplies or kitchen utensils in commercial or residential applications.



### SPECIFICATIONS

- 3/4 extension
- .50" [12.7 mm] side space
- Drawers up to 16" [406 mm] wide
- Lever disconnect
- Steel ball bearings
- Lengths 10"-28" [250-700 mm]
- Clear zinc or black finish

### SPECIAL FEATURES

- Low profile
- Hold-in detent
- Cam Drawer Adjust
- 32 mm and traditional hole pattern

Optional face frame bracket kit:  
P/N 4180-0321-XE

Pilaster mounting kit:  
P/N 4180-0266-XE



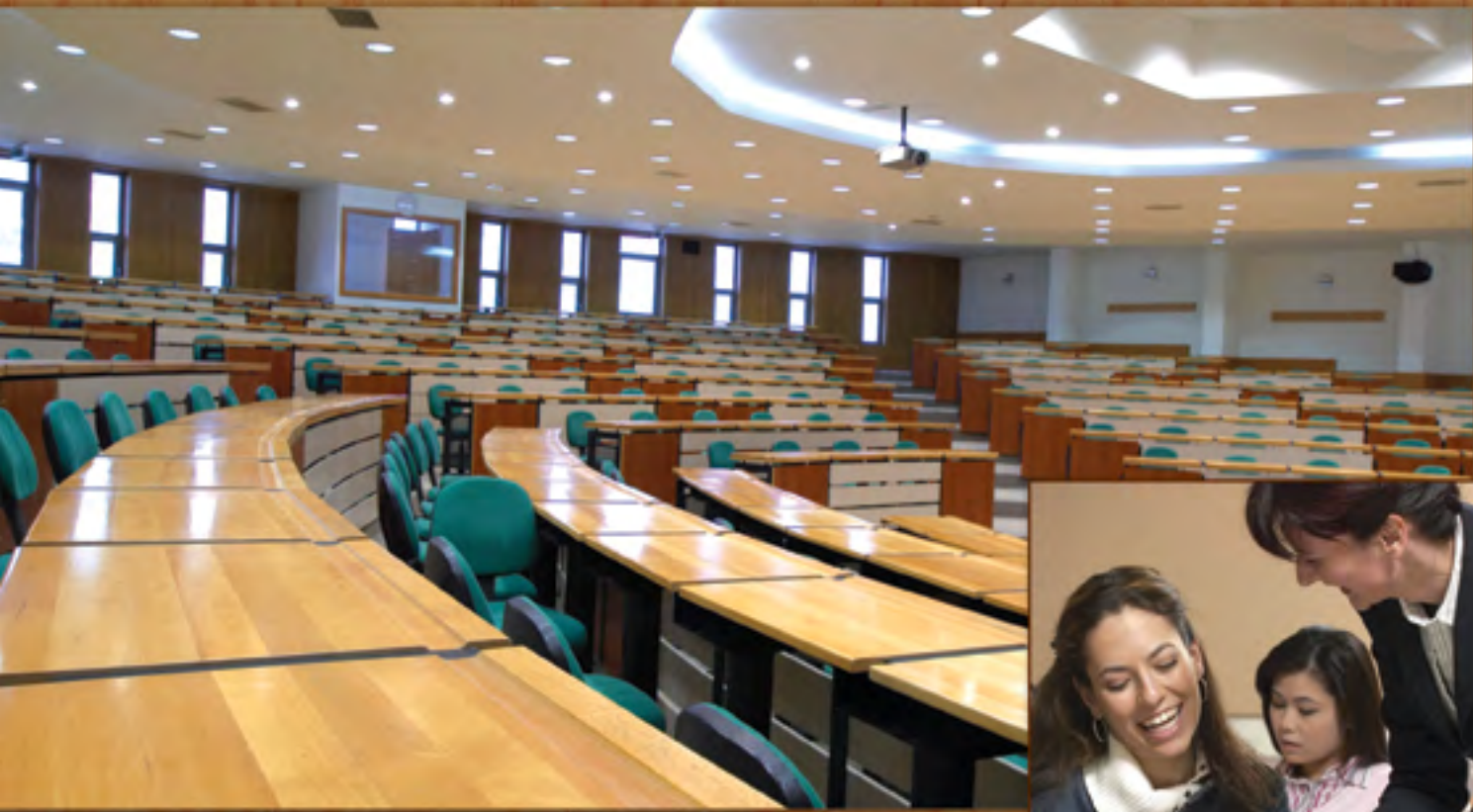

90–100 POUNDS  
DRAWER WIDTHS 16–30 INCHES

MODEL	LOAD RATING	TRAVEL	DRAWER WIDTH	DETENT	DISCONNECT	PAGE
3732	100 lbs. [45 kg]	Full	16" [406 mm]	Hold-in	Push latch	11
3132EC/SC	100 lbs. [45 kg]	Full	30" [762 mm]	Hold-in	Lever	12
7432	100 lbs. [45 kg]	Full	24" [610 mm]	Hold-in	Rail	13
7434	100 lbs. [45 kg]	1" Over [25.4 mm]	24" [610 mm]	Hold-in	Rail	13
3017	100 lbs. [45 kg]	1" Over [25.4 mm]	24" [610 mm]	Hold-in	Rail	13
3832	100 lbs. [45 kg]	Full	16" [406 mm]	Hold-in	Lever	14
3834	90 lbs. [41 kg]	1" Over [25.4 mm]	16" [406 mm]	Hold-in	Lever	14
3864	90 lbs. [41 kg]	1" Over [25.4 mm]	16" [406 mm]	Hold-in	Lever	14

## 3732

100-lb. [45 kg] load rating

*This low profile slide has a convenient face frame mounting hole at the front of the slide. Ideal for kitchen, bathroom, or institutional box drawers.*



### SPECIFICATIONS

- Full extension
- .50" [12.7 mm] side space
- Drawers up to 16" [406 mm] wide
- Unhanded push latch disconnect
- Ball bearings:
  - Zinc and black finish—steel
  - White finish—steel and polymer
- Even lengths 12"–28" [305–711 mm]
- Clear zinc, white, or black finish
- Available in Production Packaging (FP)

Optional rear face frame bracket mounting kit:

P/N 4180-0431-XE

Rear Face Frame Bracket

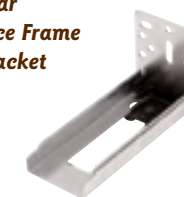

### SPECIAL FEATURES

- Lowest profile side mount slide
- Hold-in detent to prevent drawer roll-out and bounce-back
- Enhanced silencing in and out
- 32 mm and traditional hole pattern
- Front face frame mounting hole

### SAVE TIME!

PRODUCTION PACKAGING (FP)  
AVAILABLE FOR  
ALL LENGTHS



*Slides are shipped with the drawer members disconnected from the cabinet members. The two types of members are packaged separately within the same box, allowing the drawer members to be distributed to a different area of the shop for installation.*



# 3132 Eclipse

100-lb. [45 kg] load rating

Available with Easy-Close or Self-Closing options, the Eclipse undermount products offer concealed slide solutions for both commercial and residential installations.



## SPECIFICATIONS

- Full extension
- Accommodates drawers up to 30" [762 mm] wide
- Front lever disconnect
- Steel and polymer ball bearings
- Even lengths 12"-28" [305-711 mm], plus 15" [381 mm] and 21" [533 mm]; 10" [254 mm] available for 3132 EC only
- Clear zinc finish

## SPECIAL FEATURES

- Face frame and frameless compatible
- 1/4-turn cam lock to secure drawer front position
- Vertical and horizontal cam adjustment up to 1/8"
- Slotted holes for front-to-back adjustment
- Self-adjusting drawer depth
- Optional rear face frame brackets provide 2" of depth adjustment.
- 32 mm and traditional hole pattern



### 3132EC - EASY-CLOSE

Brings drawers to a gentle close

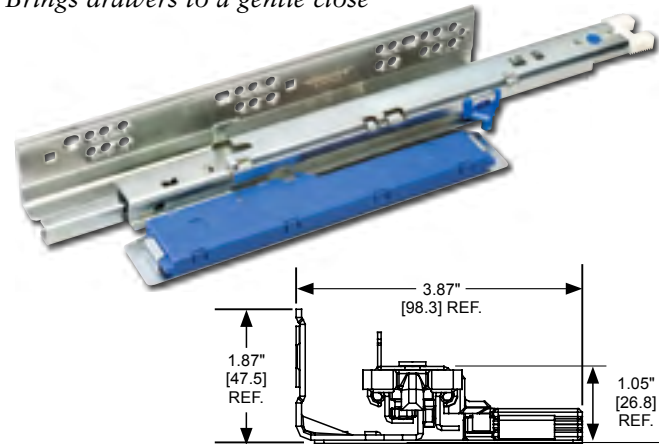

### 3132SC - SELF-CLOSING

Closes drawers and keeps them closed

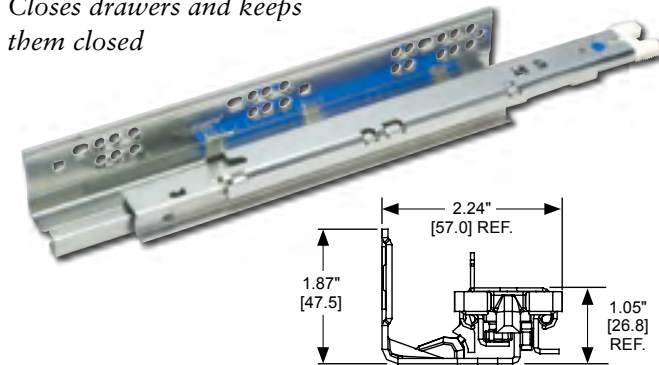

## OPTIONAL KITS

Tool kit:

P/N 4180-0603-XE

Drill jig:

P/N 4180-0568-XE

Rear face frame bracket kit (w/disk):

P/N 4180-0560-XE

Slotted rear face frame bracket kit (w/out disk):

P/N 4180-0656-XE

Bottom mount bracket kit:

P/N 4180-0569-XE

Inset face frame bracket kit:

P/N 4180-0604-XE

Bottom Inset face frame bracket kit:

P/N 4180-0605-XE

Vertical mount disconnect:

P/N 4180-0584-XE

Standard horizontal mount:

P/N 4180-0559-XE

# 7432/7434

100-lb. [45 kg] load rating

The top-quality choice for file, desk, and storage drawers in commercial or residential applications.

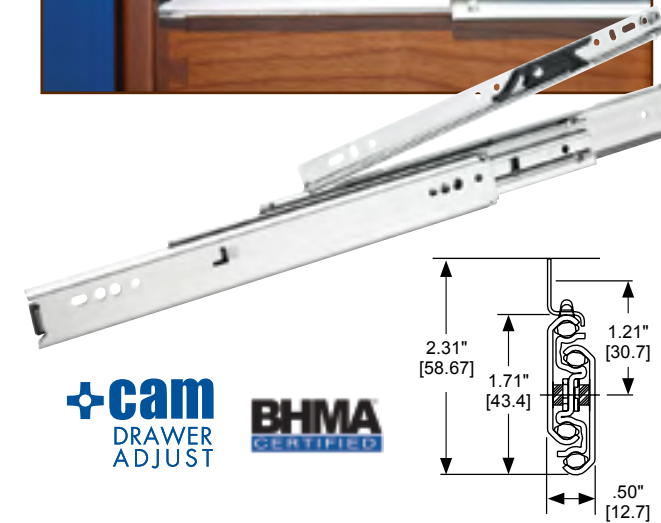

## SPECIFICATIONS

- .50" [12.7 mm] side space
- Drawers up to 24" [610 mm] wide
- Rail mount/disconnect
- Steel ball bearings
- Even lengths 12"-28" [300-700 mm]
- Clear zinc or black finish

## SPECIAL FEATURES

- Progressive movement
- Hold-in detent to prevent drawer roll-out and bounce-back
- Cam Drawer Adjust
- 32 mm and traditional hole pattern

### 7432

- Full extension

### 7434

- 1" [25.4 mm] over travel

# 3017

100-lb. [45 kg] load rating

Designed for wider desk and credenza drawers. The rail mount disconnect and polymer ball bearings provide smooth and quiet operation.

Furniture by [www.diamondcase.com](http://www.diamondcase.com)

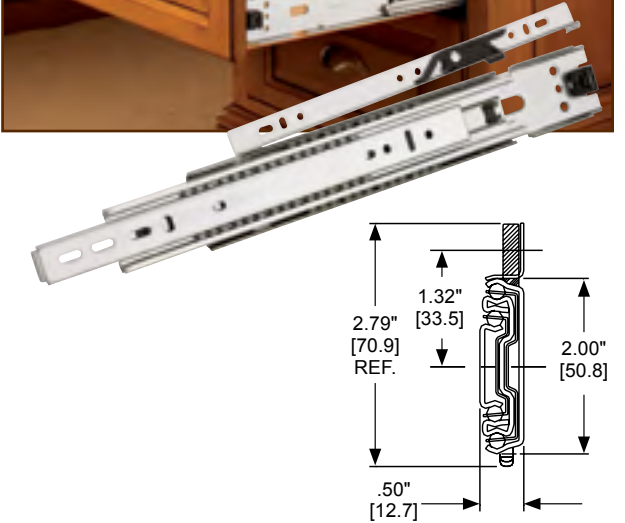

## SPECIFICATIONS

- 1" [25.4 mm] over travel
- .50" [12.7 mm] side space
- Drawers up to 24" [610 mm] wide
- Rail mount/disconnect
- Polymer ball bearings
- Hold-in detent to prevent drawer roll-out and bounce-back
- Even lengths 12"-28" [305-711 mm]
- Clear zinc or black finish



# 3832 Family

90–100-lb. [41–45 kg] load rating

This group of products offers a number of options including self-closing, detent out, weather-resistant, touch release, and easy-close.

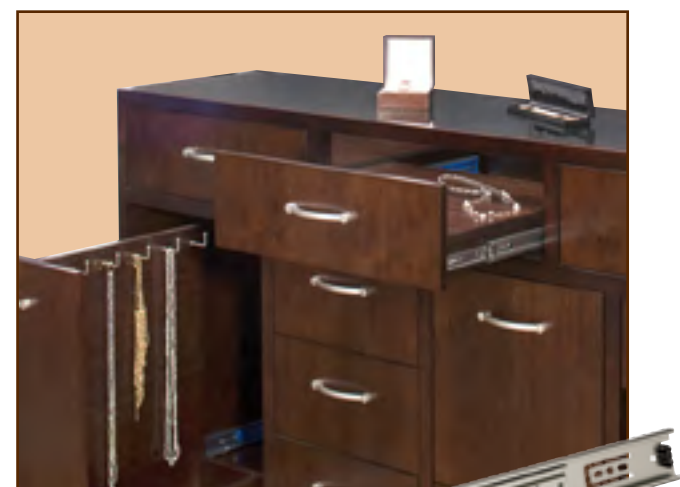

3832TR eliminates the need for knobs or pulls.



CH3832 is ideal for environments subjected to indirect humidity.

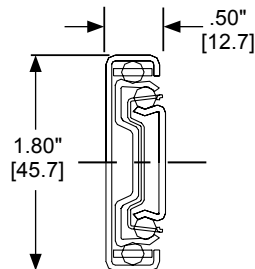
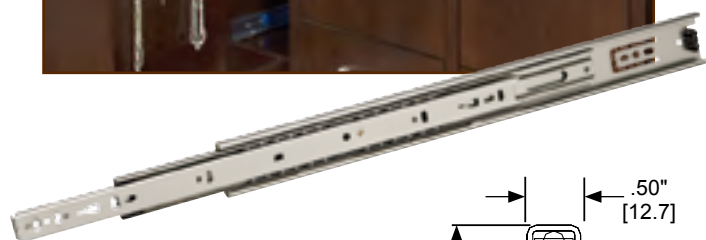

## SPECIFICATIONS

- Full extension
- .50" [12.7 mm] side space
- Drawers up to 16" [406 mm] wide
- Lever disconnect
- Ball bearings:
  - Zinc and black finish–steel
  - White finish–steel and polymer
- Clear zinc, black, or white finish\*\*

## SPECIAL FEATURES

- Hold-in detent to prevent drawer roll-out and bounce-back
- Cam Drawer Adjust
- Easy access to mounting holes
- Silenced in and out
- 32 mm and traditional hole pattern

\*\* Finish options vary by model.

Optional accessories for pilaster and face frame mounting:

- Pilaster kit:  
P/N 4180-0266-XE
- Face frame kit:  
P/N 4180-0322-XE
- 3832TR/3832HDTR  
Face frame kit:  
P/N 4180-0661-XE



Face Frame Bracket Kit



**SAVE TIME!**  
**PRODUCTION PACKAGING (FP)**  
**MODEL 3832**  
**10"–28" LENGTHS**  
**MODEL 3834**  
**ALL LENGTHS**

Slides are shipped with the drawer members disconnected from the cabinet members. The two types of members are packaged separately within the same box, allowing the drawer members to be distributed to a different area of the shop for installation.

## A host of options to suit a variety of applications...



### 3832–CLASSIC

- Even lengths 6"–28" [154–700 mm]
- Lengths 10"–28" available in Production Packaging (FP)



### 3834–OVER TRAVEL

- 90-lb. [41 kg] load rating
- 1" [25.4 mm] over travel
- Even lengths 12"–28" [305–700 mm]
- Available in Production Packaging (FP)



### 3832SC–SELF-CLOSING\*

- Unique self-closing device
- Even lengths 12"–26" [300–650 mm]



### 3834SC–SELF-CLOSING\*

- 90-lb. [41 kg] load rating
- Unique self-closing device
- 1" [25.4 mm] over travel
- Even lengths 14"–26" [350–650 mm]

### 3832HDSC–HEAVY-DUTY SC\*

- Self-closing device has heavier spring for stronger self-closing action
- Even lengths 12"–28" [300–711 mm]



### 3832DO–DETENT OUT

- Special detent out to hold drawers or pull-out shelves in an open position
- Even lengths 10"–28" [199–700 mm]

\* Due to the self-closing feature, a stronger pull-force is required to open drawers.

### 3832TR–TOUCH RELEASE 3832HDTR–HEAVY-DUTY TR

- These products hold drawers or roll-out shelves in a closed position until activated by touch
- Even lengths 12"–28" [300–700 mm]



### CH3832–WEATHER RESISTANT

- Special coating provides eight times more protection than standard zinc finish
- Stainless steel ball retainer, ball bearings, and rivets
- Even lengths 10"–28" [199–700 mm]

### 3832EC–EASY-CLOSE\*

- Brings drawers to a gentle close
- Even lengths 14"–28" [350–705 mm]
- Not available in white finish



### 3864–MOUNTING TABS

- Mounting tabs provide quick installation of drawer boxes, trays, or shelves.
- 90-lb. [41 kg] load rating
- 1" [25.4 mm] over travel
- Even lengths 12"–28" [305–711 mm]





100-966 POUNDS  
DRAWER WIDTHS 18-42 INCHES



MODEL	LOAD RATING	TRAVEL	DRAWER WIDTH	DETENT	DISCONNECT	PAGE
4032	150 lb. [68 kg]	Full	27" [686 mm]	Hold-in	Rail	17
4033	100 lb. [45 kg]	Full	18" [457 mm]	Hold-in	Rail	17
4034	150 lb. [68 kg]	1.5" Over [38.1 mm]	24" [610 mm]	Hold-in	Rail	17
4035	100 lb. [45 kg]	1.5" Over [38.1 mm]	18" [457 mm]	Hold-in	Rail	17
3641 Interlock	180 lb. [82 kg]	1" Over [25.4 mm]	42" [1067 mm]	Hold-in	Rail	18
3640A	200 lb. [91 kg] Side mount 75 lb. [34 kg] Flat mount	1" Over [25.4 mm]	42" [1067 mm] 24" [610 mm]	Hold-in	Rail None	18
7950	350 lb. [159 kg]	Full	42" [1067 mm]	Hold-in	None	19
7957	350 lb. [159 kg]	Full	42" [1067 mm]	Hold-in	Lever	19
9301	500 lb. [227 kg] Moderate use 400 lb. [181 kg] Frequent use 300 lb. [136 kg] Mobile/Vehicular 150 lb. [68 kg] Flat mount 500 lb. [227 kg] Bracket mount 350 lb. [159 kg] Bracket mount	Full	18" [457 mm] 42" [1067 mm] 32" [813 mm] 32" [813 mm] 18" [457 mm] Up to 42" [1067 mm]		None	20
AL4140	882 lbs. [400 kg]	Full	Load based on 24"	Hold-in	None	21
AL4120	966 lbs. [438 kg]	3/4	Load based on 24"	Hold-in	None	21

## 400 series

100-150-lb. [45-68 kg] load rating

Smooth and quiet operation for deep drawers.

Furniture by [www.diamondcase.com](http://www.diamondcase.com)

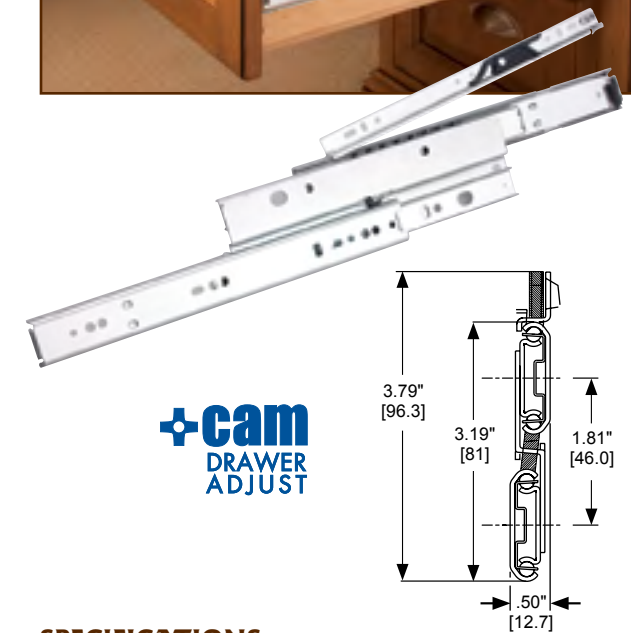

**cam**  
DRAWER  
ADJUST

### SPECIFICATIONS

- .50" [12.7 mm] side space
- Rail mount/disconnect
- Even lengths 12"-28" [300-700 mm]
- Clear zinc or black finish

### SPECIAL FEATURES

- Progressive movement
- Hold-in detent to prevent drawer roll-out and bounce-back
- Cam Drawer Adjust
- Silenced in and out
- 32 mm and traditional hole pattern

### 4032-For wider drawers

- Drawer widths up to 27" [686 mm]
- 150-lb. [68 kg] load rating
- Full extension
- Steel ball bearings

### 4033

- Drawer widths up to 18" [457 mm]
- 100-lb. [45 kg] load rating
- Full extension
- Polymer ball bearings  
(Not recommended for lateral files)

### 4034-Over travel with a higher load

- Drawer widths up to 24" [610 mm]
- 150-lb. [68 kg] load rating
- 1.5" [38.1 mm] over travel
- Steel ball bearings

### 4035-Over travel

- Drawer widths up to 18" [457 mm]
- 100-lb. [45 kg] load rating
- 1.5" [38.1 mm] over travel
- Polymer ball bearings  
(Not recommended for lateral files)





## 3641

180-lb. [82 kg] load rating

Suitable for commercial or residential filing cabinet drawers requiring interlock.



### SPECIFICATIONS

- 1" [25.4 mm] over travel
- .89" [22.6 mm] side space
- Drawers up to 42" [1067 mm] wide
- One piece rail-and-pocket mount/disconnect system
- Steel ball bearings
- Even lengths 14"-28" and 17" [353-709 and 429 mm]
- Clear zinc or black finish

### SPECIAL FEATURES

- Front location of interlock eliminates reaching during installation
- Interfaces with central locking system
- Cut-to-length aluminum connecting rods
- Hold-in detent to prevent drawer roll-out and bounce-back
- Silenced in and out
- 32 mm and traditional hole pattern

Optional gang locking system:  
P/N 4180-0345-XE

## 3640A

200-lb. [91 kg] load rating

Can be side or flat mounted. Recommended for wider lateral file drawers.



### SPECIFICATIONS

- 1" [25.4 mm] over travel
- .89" [22.6 mm] side space
- Adapter rail mount/disconnect
- Steel ball bearings
- Even lengths 12"-28" [305-711 mm]
- Clear zinc or black finish

### SPECIAL FEATURES

- Dual mounting options:
  - 200 lb. [91 kg] side mount
    - drawer width 42" [1067 mm]
  - 75 lb. [34 kg] under/flat mount
    - drawer width 24" [610 mm]
- Hold-in detent to prevent drawer roll-out and bounce-back
- 32 mm hole pattern

## 7950/7957

New!

350-lb. [159 kg] load rating

An intermediate load-rating choice for wide drawers in kitchens, store fixtures, or institutional storage applications.



### SPECIFICATIONS

- Full extension
- .75" [19.1 mm] side space
- 7950: non-disconnect  
7957: handed lever disconnect
- Accommodates drawers up to 42" [1067 mm] wide
- Steel ball bearings
- Even lengths 12"-36" [305-914 mm]
- Clear zinc finish

### SPECIAL FEATURES

- May be side or flat mounted:
  - Side mount load capacity up to 350 lbs. [159 kg].
  - Flat mount load capacity up to 150 lbs. [68 kg].
- Bridged ball retainer design prevents retainer migration.

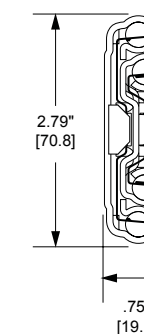

**7950**

Non-Disconnect

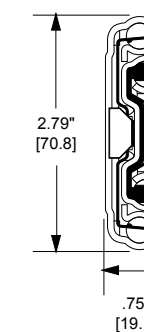

**7957**

Handed Lever  
Disconnect



# 9301

150–500-lb. [68–227 kg] load rating

Well suited for large pantry pull-outs, vehicular storage, or other drawers with a heavier load.

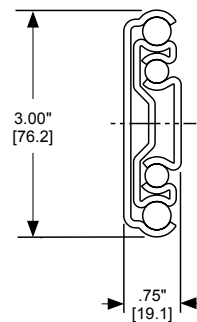

## LOAD RATINGS

**Flat mount:** 150 lb. [68 kg]\*  
Drawer widths up to 32" [813 mm]

**Mobile applications:** 300 lb. [136 kg]\*  
Drawer widths up to 32" [813 mm]

**Frequent usage:** 400 lb. [181 kg]  
Drawer widths up to 42" [1067 mm]

**Moderate usage:** 500 lb. [227 kg]\*  
Drawer widths up to 18" [457 mm]

**Bracket-mounted:** 350 lb. [159 kg]  
Drawer widths up to 42" [1067 mm]

**Bracket-mounted:** 500 lb. [227 kg]  
Drawer widths up to 18" [457 mm]

## ACCESSORY PLATFORM BRACKET KITS

- Provides six additional mounting configurations
- Available in lengths of 12", 16", 22", and 28" [305, 406, 559, and 711 mm]
- Four bracket lengths have been designed to be used individually or in combination to accommodate all slide lengths
- See technical sheet or [www.accuride.com](http://www.accuride.com) for bracket kit ordering information
- Clear zinc finish

### Four Bottom-Mount Options

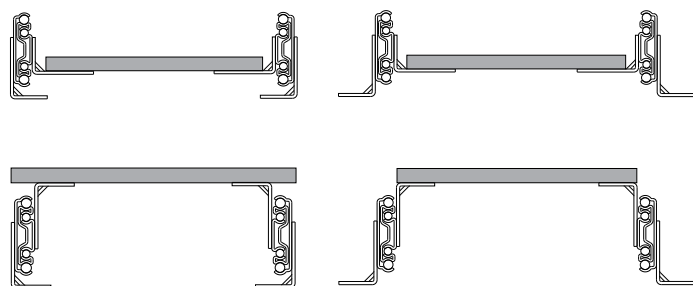

### Two Side-Mount Options

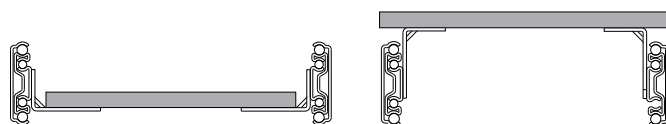

\* Load ratings based on 10,000 cycle test

**Caution:** This slide must never be used as a pull-out step, platform or any other application supporting human weight, as injury may result.

## SPECIFICATIONS

- Full extension
- .75" [19.1 mm] side space
- Non-disconnect
- Silenced in and out
- Steel ball bearings
- Even lengths 10"–36", 40", 42", 44", 48", and 60" [254–914, 1016, 1067, 1118, 1219, and 1524 mm]
- Clear zinc finish

# Super Heavy-Duty Aluminum Slides

## AL4140

882-lb. [400 kg] load rating

Super heavy duty, with full extension in lightweight aluminum that offers corrosion resistance.

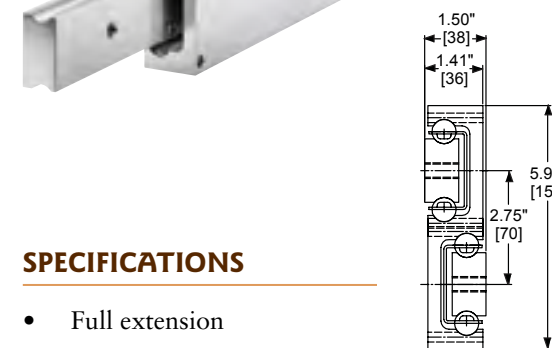

## SPECIFICATIONS

- Full extension
- 1.5" [38 mm] side space
- Load rating based on a pair of slides spaced 24" [610 mm] apart and tested to 10,000 cycles.
- Non-disconnect
- Stainless steel ball bearings
- Lengths: 16", 20", 24", 28", 32", 36", 40", 44", and 48" [400, 500, 600, 700, 800, 900, 1000, 1100, and 1200 mm]\*

## SPECIAL FEATURES

- Manufactured with lightweight aluminum, combined with stainless steel ball bearings and ball retainers to provide corrosion resistance and strength without the additional weight of steel slides.

\* The lengths indicated in inches are approximate conversions from the metric measurements. Please see technical sheet for exact dimensions.

## AL4120

966-lb. [438 kg] load rating

Super heavy duty, 3/4 extension slide in lightweight aluminum that offers corrosion resistance.

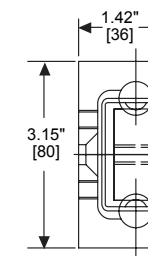
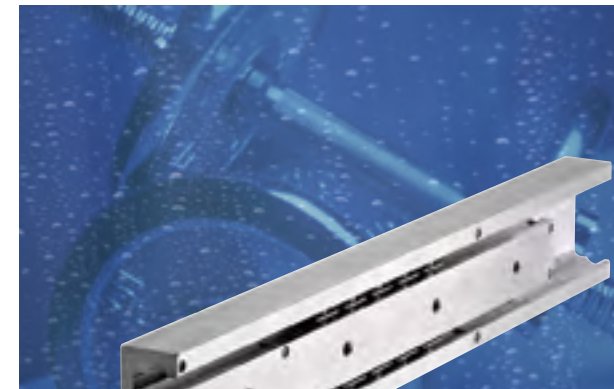

## SPECIFICATIONS

- 3/4 extension
- 1.42" [36 mm] side space
- Load rating based on a pair of slides spaced 24" [610 mm] apart and tested to 10,000 cycles.
- Non-disconnect
- Stainless steel ball bearings
- Lengths: 16", 20", 24", 28", 32", 36", 40", 44", and 48" [400, 500, 600, 700, 800, 900, 1000, 1100, and 1200 mm]\*

## SPECIAL FEATURES

- Manufactured with lightweight aluminum, combined with stainless steel ball bearings and ball retainers to provide corrosion resistance and strength without the additional weight of steel slides.

\* The lengths indicated in inches are approximate conversions from the metric measurements. Please see technical sheet for exact dimensions.





14.5–300 POUNDS

MODEL	LOAD RATING	MAXIMUM SIZE	APPLICATION BENEFITS	PAGE
CBLift-0019 Ascent	14.5 lbs. [6.6 kg]	N/A	Push-to-operate mechanical lift for screens up to 17.5" tall and 22" diagonal.	23
CB3620-258TV TV Swivel	225 lbs. [102 kg]	N/A	Accuride's TV Swivel handles televisions up to 36" diagonal.	23
CBLift-050 Quick Lift	120 lbs. [54 kg]	N/A	Remote-controlled lift that carries flat-panel televisions up to 50" diagonal x 33.5" tall.	24
CBMAC-50 Media Access Center	150 lbs. [68 kg]	Shelving Units 20-3/4" wide x 18" deep up to 36" tall	A smaller capacity M.A.C. comprised of a single swivel assembly that is installed at the bottom of a cabinet.	25
CBMAC-100 Media Access Center	300 lbs. [136 kg]	Shelving Units 20-3/4" wide x 18" deep up to 55" tall	The M.A.C. provides easy access to A/V component wiring. Suitable for security and electronic control centers, sound systems, lecterns, etc.	25

## CBLift-0019 Ascent

14.5-lb. [6.6 kg] load rating

The Ascent is a push-to-operate mechanical lift that provides access and conceals screens in desks and other cabinetry.

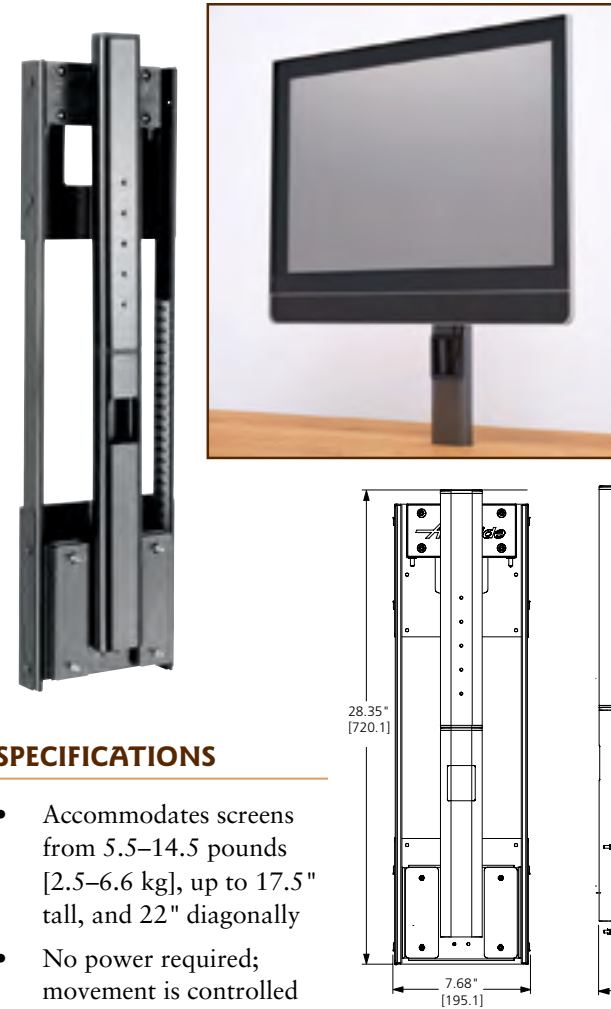

### SPECIFICATIONS

- Accommodates screens from 5.5–14.5 pounds [2.5–6.6 kg], up to 17.5" tall, and 22" diagonally
- No power required; movement is controlled by counterbalancing weights
- Swivels ± 112.5° for expanded viewing access
- Black electroplate finish

### SPECIAL FEATURES

- Easy to install
- Unit raises 21 inches in less than 2 seconds.

### OPTIONAL KITS

<b>Additional Weight Pack</b> P/N 2990-9774-BE	<b>VESA 18° Tilt Bracket</b> P/N 2990-9776-BE
<b>Weight Extension Plate Kit</b> P/N 2990-9775-BE	<b>VESA Fixed Bracket</b> P/N 2990-9777-BE

Note: Packaging includes wire management, cable control kit, and one weight pack.

## CB3620-258TV

225-lb. [102 kg] load rating\*

A smooth pull-out swivel that holds televisions up to 36" diagonal.

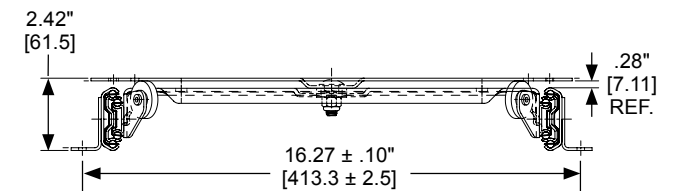

### SPECIFICATIONS

- 14" [356 mm] extension
- Holds televisions up to 36" [914 mm] diagonal
- Steel ball bearings
- Black zinc plating

### SPECIAL FEATURES

- Hold-in detent to prevent roll-out and bounce-back
- Smooth, stable movement
- 360° swivel
- Silenced in and out

\* Load rating based on 10,000 cycle test.



# CBLift-050 Quick Lift

120-lb. [54 kg] load rating

A remote-controlled mechanism that carries flat-panel televisions in audiovisual, home theater, or entertainment center cabinetry.



Standard and key fob remote controls

## OPTIONAL KITS

Replacement Remote Controls:  
P/N 4180-0654-XE

Fixed Lid Bracket Kit:  
P/N 4180-0650-XE

## SPECIFICATIONS

- Carries flat-panel television screens up to 50" diagonal and 33.5" tall
- Fits standard cabinets 34" tall
- Minimum cabinet opening 30" w x 10" d
- Supplied pre-mounted to a 3/4" thick plywood backing board
- Black finish

## SPECIAL FEATURES

- Reinforced steel rails for strength and stability
- Auto-reverse mechanism reverses lift movement when an obstruction is encountered
- Standard- and key fob-sized remote controls
- Control box mounted on the assembly for manual operation
- Cable management
- UL/CE approved components
- Designed for turn-key installation; no adjustments, modifications, or alterations necessary.

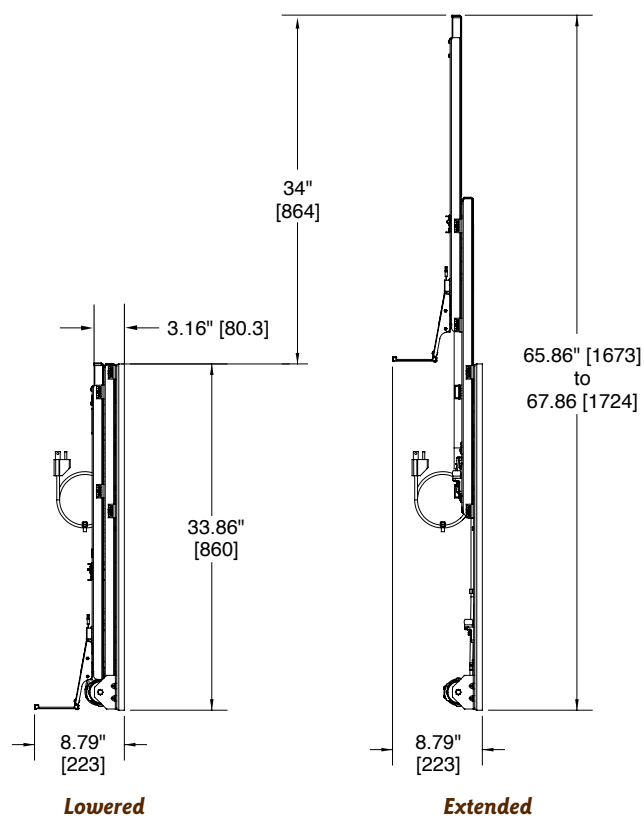

# M.A.C.s

150–300-lb. [68–136 kg] load rating

The M.A.C. gives end-users full access to media components and provides aesthetic integration into surrounding cabinetry. It is suitable for security and electronic control centers, sound system components, lecterns, and other electronic set ups.

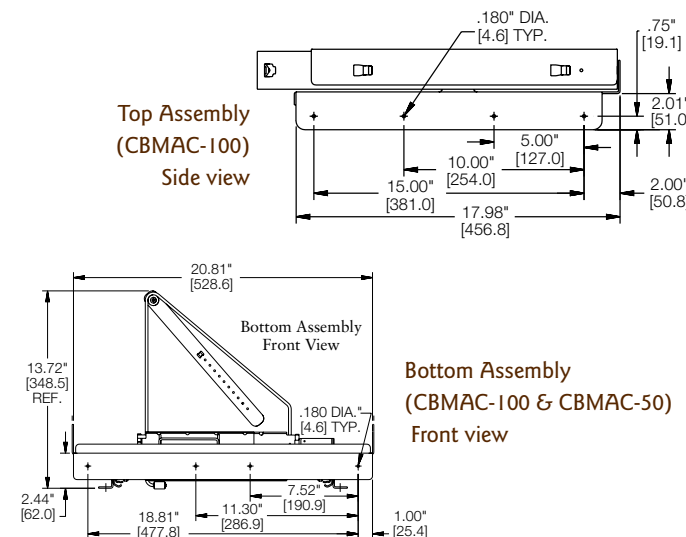

## SPECIAL FEATURES

- 90° rotation in both directions provides full access to the back of shelving units
- Rotation function actuates only when slides are fully extended preventing damage to the inside of the cabinet
- Detent-in and detent-out holds shelving units securely in place
- Cable management helps keep wires clear of the slides
- Cable clips attach to shelves to keep wires neatly bundled at the back of components
- Power strip and cable ties also included

## CBMAC-100

- 300-lb. [136 kg] load rating\*
- Includes top and bottom swivel assemblies
- Accommodates shelving units up to 55" [1397 mm] tall

## CBMAC-50

- 150-lb. [68 kg] load rating\*
- Includes one swivel assembly
- Accommodates shelving units up to 36" [914 mm] tall

Additional cable clips (2):  
P/N 4180-0566-XE

\* Load ratings based on 10,000 cycle test

## SPECIFICATIONS

- Accommodates shelving units 20-3/4" [527 mm] wide by 18" [457 mm] deep
- Full 20" [559 mm] extension
- Slides black electroplate; swivel plate black powdercoat
- Compatible with EIA mounting standards
- Steel ball bearings





25-75 POUNDS

MODEL	MAXIMUM DOOR WEIGHT	MOUNTING	MAXIMUM DOOR SIZE	PAGE
117	25 lbs. [11 kg]	Horizontal or Vertical	24" w x 36" h [610 mm x 914 mm]	27
1145 Over-the-top	30 lbs. [14 kg]	Horizontal	Up to 36" wide [914 mm]	27
1155 Easy-Down®	30 lbs. [14 kg]	Horizontal	Up to 48" wide [1219 mm]	28
123/1234	30 lbs. [14 kg]	Horizontal or Vertical	24" w x 42" h [610 mm x 1067 mm]	28
1321 Pro Pocket	30 lbs. [14 kg]	Vertical	24" w x 42" h [610 mm x 1067 mm]	29
1332/1432 Anti-Rak cable	75 lbs. [34 kg]	Vertical	26" w x 78" h [660 mm x 1981 mm]	30

## 117

25-lb. [11 kg] load rating

Suitable for entertainment cabinets  
and office storage doors.

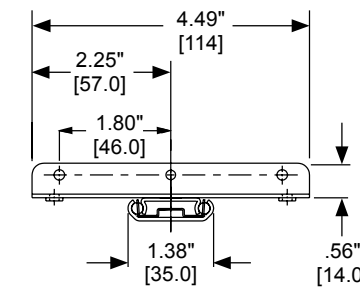
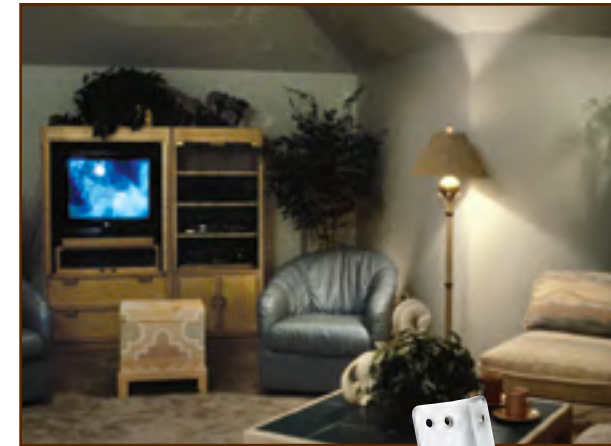

### SPECIFICATIONS

- Doors up to 24" w x 36" h [610 mm x 914 mm]
- Steel ball bearings
- Even lengths 12"-28" [305-711 mm]
- Clear zinc or black finish

### SPECIAL FEATURES

- Optional detent-out feature prevents door sag
- No partition required
- Silenced in and out

Horizontal mounting requires pivot roller kit:  
P/N 4180-0302-XE

## 1145

30-lb. [14 kg] load rating

Medium duty for armoires, storage cabinets, and  
entertainment center doors.

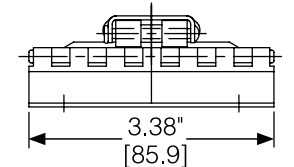

### SPECIFICATIONS

- 36" [914 mm] maximum door width
- Steel and polymer ball bearings
- Lengths 10"-24" [252-608 mm]
- Clear zinc or black finish

### SPECIAL FEATURES

- Minimum door racking
- Pin hinge included

Mounting bracket kit (zinc):  
P/N 4180-0325-XE

Mounting bracket kit (black):  
P/N 4180-0326-XE



## I 155 Easy-Down®

30-lb. [14 kg] load rating

The Easy-Down® has a motion control system to ensure overhead doors close safely.



### SPECIFICATIONS

- Accommodates door widths up to 48" [1219 mm]
- Steel ball bearings
- Even lengths 12"-24" [303-608 mm]
- Clear zinc or black finish

### SPECIAL FEATURES

- Over-the-top design provides no loss of normal storage space
- Protects user from rapid drop of door
- Door closing speed remains similar on both light and heavy doors
- Easy installation—requires few or no cabinet modifications
- Cylinder cover cap provides a finished look (not shown)

Mounting bracket kit (zinc):  
P/N 4180-0325-XE

Mounting bracket kit (black):  
P/N 4180-0326-XE

The cylinder for the Easy-Down® is covered by a five year limited warranty.

## I 23/I 234

30-lb. [14 kg] load rating

Accommodates taller kitchen cabinet and entertainment center doors.



### SPECIFICATIONS

- Doors up to 24" [610 mm] wide by 42" [1067 mm] tall
- Hold-out detent
- Steel ball bearings
- Even lengths 12"-28" [305-711 mm]

**I 23**—35 mm inset hinges included  
Black zinc finish—slides and hinges

**I 234**—Hinges purchased separately  
Black zinc finish—slides only

### OPTIONAL HINGE KITS

35 mm hinge:  
P/N 4180-0391-XE

Overlay (40 mm):  
P/N 4180-0314-XE

Thick door (40 mm):  
P/N 4180-0313-XE

## I 321 Pro Pocket

30-lb. [14 kg] load rating

The Pro Pocket is a full 3/4 inch overlay Flipper Door Slide® with special features that virtually eliminate door damage.



### MODEL I 321

Full 3/4" Overlay  
Flipper Door Slide®

### SPECIFICATIONS

- Doors up to 42" [1067 mm] tall by 24" [610 mm] wide
- Steel ball bearings
- Even lengths 16"-28" [405-710 mm]
- Black electroplate finish

### SPECIAL FEATURES

- Attached brackets provide easy partition installation and removal
- Auto-open feature pushes cabinet doors open the last 1-1/4" [32 mm] of travel to ensure doors are fully extended
- Skid blocks with indexing marks ease installation, and protect door face, top, and bottom
- Cover caps provide aesthetic finish





# 1332/1432 Anti-Rak Cable System

75-lb. [34 kg] load rating

These slides are designed for taller, heavier doors used on armoires, or audio/visual and home entertainment cabinetry.

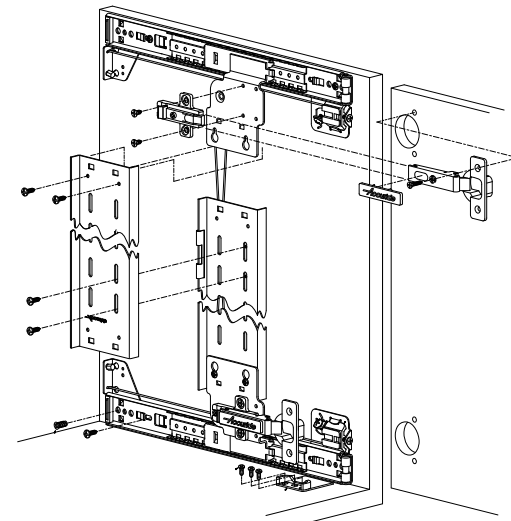

## SPECIFICATIONS

- Door heights up to 78" [1981 mm]
- Door widths to 26" [660 mm]
- For doors 36"-78" [914-1981 mm] tall additional hinges required—see below
- Lengths 12"-32" [303-813 mm]
- Hold-out detent
- Silenced in and out
- Steel ball bearings
- Standard black or optional clear zinc finish

**1332**—35 mm inset hinges included

**1432**—Hinges purchased separately

### Extra Hinge Kit (35 mm inset):

P/N 4180-0407-XE

Black finish

P/N 4180-0389-XE

Zinc finish

### Hinge Carrier Strip Kit:

(required for doors 36"-78" tall [914-1981 mm])

P/N 4180-0408-XE

Black finish

P/N 4180-0410-XE

Zinc finish

### Optional 40 mm hinge kits:

P/N 4180-0292-XE

7/16" overlay for doors up to 3/4" [19.1 mm]

P/N 4180-0394-XE

Thick doors up to 1-1/4" [31.8 mm]

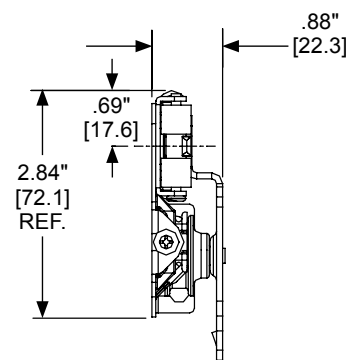
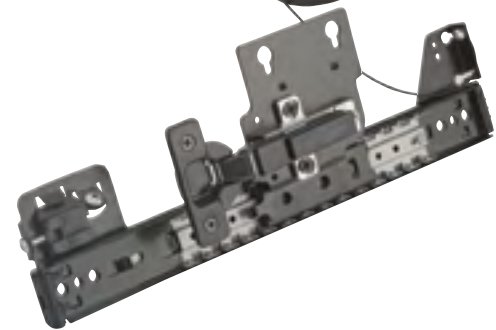

45-350 POUNDS

MODEL	LOAD	TRAVEL RATING	DRAWER WIDTH	DETENT	DISCONNECT	PAGE
2006 Pencil drawer slide	45 lb. [20 kg]	3/4	16" [406 mm]	None	Friction	32
2109 Suspended drawer slide	75 lb. [34 kg]	3/4	16" [406 mm]	Hold-in and -out	Lever	32
CBERGO-TRAY 200	-	3/4	29.6" [751 mm]	Hold-in and -out	None	33
CBERGO-TRAY 300 - Deluxe	-	Full	29.6" [751 mm]	Hold-in, -out, and intermed.	None	33
SS2028 Stainless Steel	100 lb. [45 kg]	3/4	18" [457 mm]	Hold-in	None	34
SS0330 Stainless Steel	143 lbs. [65 kg]	Full	18" [457 mm]	Hold-in	None	34
SS5322 Stainless Steel	265 lb. [120 kg]	Over	18" [457 mm]	Hold-in	Bracket	35
SS5321 Stainless Steel	350 lb. [159 kg]	Over	18" [457 mm]	Hold-in	None	35
2019 Suspended-shelf slide	75 lb. [34 kg]	3/4	16" [406 mm]	Hold-out	Lever	36
2002 Two-way travel slide	50 lb. [23 kg]	3/4	12" [305 mm]	Center	None	36
0363 Two-way travel slide	100 lb. [45 kg]	Full	18" [457 mm]	Center	None	37
322 Pull-out shelf	100 lb. [45 kg]	.88" Over [22 mm]	16" [406 mm]	None	None	38
340 Butcher block slide	110 lb. [50 kg]	Full	18" [457 mm]	None	Bracket	38
301-2590 Pull-out storage slide	155 lb. [70 kg]	.83" Over [21 mm]	16" [406 mm]	Hold-in	None	39
3600-200/3600-201 StowAway slides	175 lb. [79 kg]	Full	16" [406 mm]	None	Lever	39



## 2006

45-lb. [20 kg] load rating

Known as the pencil drawer slide, this product is designed for suspended drawers beneath desks or tabletops.

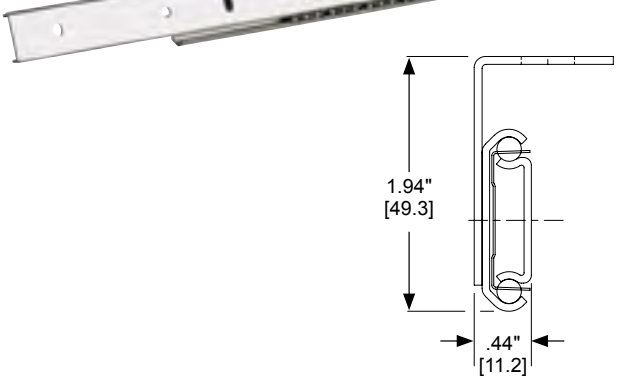

### SPECIFICATIONS

- 3/4 extension
- .44" [11.2 mm] side space
- Drawer widths up to 16" [406 mm]
- Friction disconnect
- Steel ball bearings
- Simple, fixed height bracket installation
- Lengths 12"-28" [305-711 mm]
- Clear zinc or black finish

## 2109

75-lb. [34 kg] load rating

Keyboard trays, pencil drawers, and suspended drawers requiring a detent in and out.

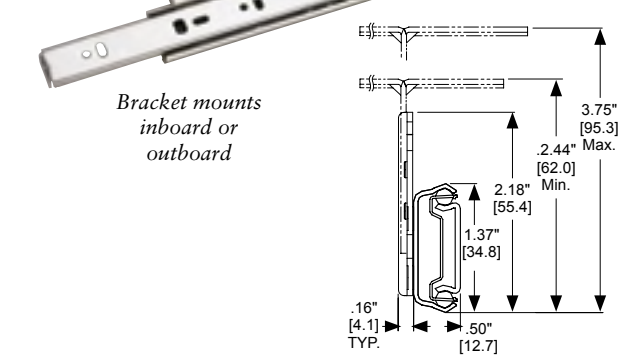

### SPECIFICATIONS

- 3/4 extension
- .50" [12.7 mm] side space (.66" [16.8 mm] with bracket)
- Drawer widths up to 16" [406 mm]
- Lever disconnect
- Steel ball bearings
- Even lengths 12"-28" [300-700 mm]
- Clear zinc or black finish

### SPECIAL FEATURES

- Hold-in and hold-out detent
- Variable height mounting brackets
- Flexibility of inboard or outboard bracket mounting

Mounting bracket kit (zinc):  
P/N 4180-0400-XE

Mounting bracket kit (black):  
P/N 4180-0401-XE

## Keyboard Systems

Ergonomically designed for home and business office workstations.



### SPECIFICATIONS

- Fully concealed slides ensure no rough or exposed edges
- Removable palm rest allows unit to accommodate virtually any size keyboard
- Extra-wide tray provides ample mousing surface
- Built-in cable management
- Removable mouse pad for left or right-handed mousing
- Typing surface held in place when in use or stored
- Mounting brackets feature seven adjustment heights and can be mounted inboard or outboard depending upon installation requirements
- Steel ball bearings

#### CBERGO-TRAY 200

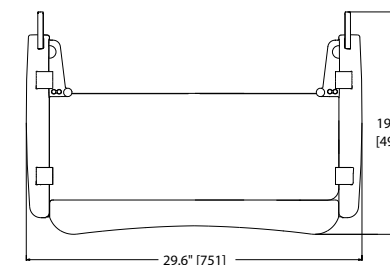

#### CBERGO-TRAY 300 - DELUXE

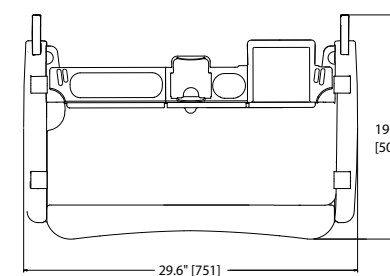

CBERGO-TRAY 200

#### CBERGO-TRAY 200

- 3/4 extension slides
- Foam palm rest
- Angled keyboard

Side view shared for both Models

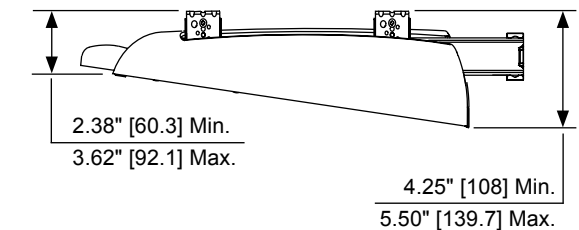

CBERGO-TRAY 300 - DELUXE  
CBERGO-TRAY 300

#### CBERGO-TRAY 300 - DELUXE

- Full extension slides
- Typing surface secures in partially or fully extended positions
- Gel palm rest
- Rear storage compartments
- Adjustable keyboard platform offers three typing positions for maximum user comfort



# Stainless Steel Slides

Presenting four stainless steel products that provide corrosion-resistant solutions for installations where exposure to moisture or high humidity is a key environmental factor. These products are a great solution for drawers or pull-out shelves in outdoor kitchens, poolside structures, greenhouses, garages, sheds and barns, marine cabinetry, and more.

## SS2028

100-lb. [45 kg] load rating

With the narrowest side space of the group, this model provides an advantage in installations where space must be maximized.

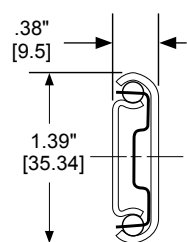

### SPECIFICATIONS

- 3/4 extension
- .38" [9.5 mm] side space
- Drawer widths up to 18" [457 mm]\*
- Non-disconnect
- Stainless steel ball bearings
- Lengths 12"-28" [300-700 mm]\*\*
- Stainless steel

### SPECIAL FEATURES

- Hold-in detent
- Corrosion resistant

## SS0330

143-lb. [65 kg] load rating

Providing a load capacity on the lighter side of the heavy-duty category, this slide is for heavier drawers or pull-out shelves in applications that require full extension.

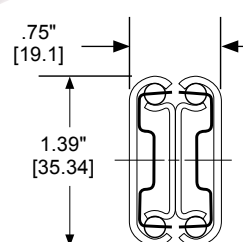

### SPECIFICATIONS

- Full extension
- .75" [19.1 mm] side space
- Drawer widths up to 18" [457 mm]\*
- Non-disconnect
- Stainless steel ball bearings
- Lengths 12"-24" [300-600 mm], plus 28" [700 mm]\*\*
- Stainless steel

### SPECIAL FEATURES

- Hold-in detent
- Corrosion resistant

\* Load rating based on 18" slides in 18" drawers cycled 80,000 times.  
 \*\* The lengths indicated in inches are approximate conversions from the metric measurements. Please see technical sheet for exact dimensions.

# Stainless Steel Slides

## SS5322

265-lb. [120 kg] load rating

The unique features on this model are over travel, for complete access to contents, and bracket mounting, which provides a disconnect method.



### SPECIFICATIONS

- Over travel
- .81" [20.7 mm] side space
- Drawer widths up to 18" [457 mm]\*
- Bracket disconnect
- Stainless steel ball bearings
- Lengths 12"-24" [300-600 mm], plus 28" [700 mm] and 31" [790 mm]\*\*
- Stainless steel

### SPECIAL FEATURES

- Hold-in detent
- Corrosion resistant
- Easy-mount brackets with locator pins to simplify disconnect.

## SS5321

350-lb. [159 kg] load rating

The most heavy-duty performer of the group, this slide offers a slightly narrower profile, over travel, and the greatest load rating of the collection.



### SPECIFICATIONS

- Over travel
- .75" [19.1 mm] side space
- Drawer widths up to 18" [457 mm]\*
- Non-disconnect
- Stainless steel ball bearings
- Lengths 12"-24" [300-600 mm], plus 28" [700 mm] and 31" [790 mm]\*\*
- Stainless steel

### SPECIAL FEATURES

- Hold-in detent
- Corrosion resistant

\* Load rating based on 18" slides in 18" drawers cycled 80,000 times.  
 \*\* The lengths indicated in inches are approximate conversions from the metric measurements. Please see technical sheet for exact dimensions.



## 2019

75-lb. [34 kg] load rating

Known as the quick-install shelf slide, this product has bent-down tabs to allow for platform-style shelf mounting.

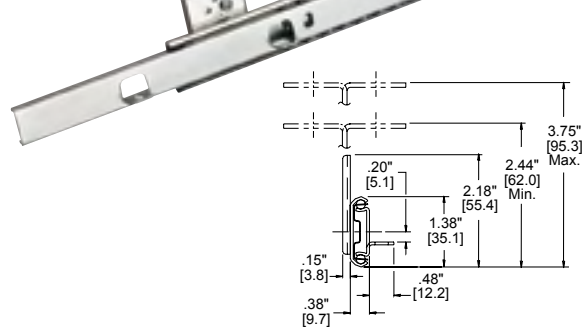

### SPECIFICATIONS

- 3/4 extension
- .38" [9.7 mm] side space
- Drawers up to 16" [406 mm] wide
- Lever disconnect
- Steel ball bearings
- Even lengths 12"–28" [305–711 mm]
- Clear zinc or black finish

### SPECIAL FEATURES

- Hold-out detent
- Optional bracket kit mounts in-board or out and provides up to 1.31" [33.2 mm] of vertical adjustment.

Optional bracket kit, zinc:  
P/N 4180-0255-XE

Optional bracket kit, black:  
P/N 4180-0257-XE

## 2002

50-lb. [23 kg] load rating

This slide offers two-way travel, which works well on pass-through shelves, kitchen islands, and medical carts.

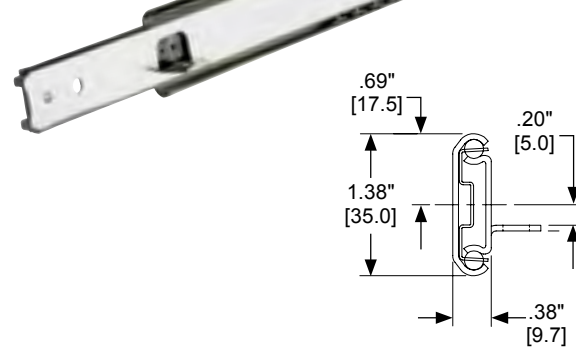

### SPECIFICATIONS

- 3/4 extension
- .38" [9.7 mm] side space
- Drawers up to 12" [305 mm] wide
- Non-disconnect
- Steel ball bearings
- Even lengths 12"–28" [305–711 mm]
- Clear zinc or black finish

### SPECIAL FEATURES

- Shelf/bottom mount tabs
- Internal detent secures in center position
- Provides access from both sides of installation

## 0363

100-lb. [45 kg] load rating

Offering full extension and two-way travel, this slide is for use in kitchen islands, dining or entertainment bars, or other cabinetry or carts that benefit from two-sided access.

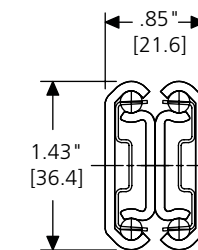

### SPECIFICATIONS

- Full extension from center point in both directions
- .85" [21.6 mm] side space
- Drawers up to 18" [457 mm] wide
- Non-disconnect
- Steel ball bearings
- Tested to 80,000 cycles
- Available lengths: 16", 20", 24", and 28" [400, 500, 600, 700 mm]
- Clear zinc finish

### SPECIAL FEATURES

- Two-way travel provides access from both sides of installation
- Hold-in detent at center keeps conveyances in position until use



## 322

100-lb. [45 kg] load rating

This pull-out shelf slide is designed for entertainment center shelves, appliance drawers, and pan shelves.

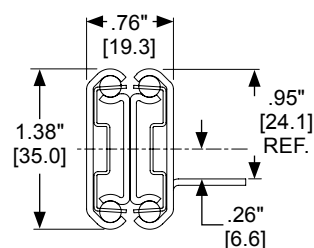

## SPECIFICATIONS

- Full extension + .88" [22.4 mm]
- .76" [19.3 mm] side space
- Drawers up to 16" [406 mm] wide
- Non-disconnect
- Tab mounting
- Steel ball bearings
- Even lengths 12"–28" [305–711 mm]
- Clear zinc or black finish

## 340

110-lb. [50 kg] load rating

Known as the butcher block slide, model 340 is ideal for cutting boards, printer, and work surface shelves.

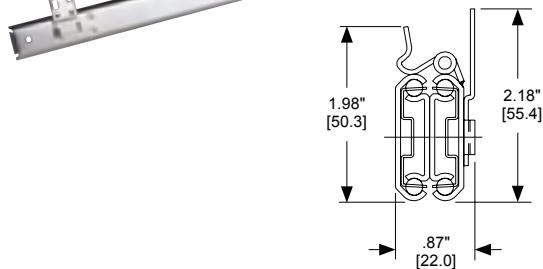

## SPECIFICATIONS

- Full extension
- .87" [22 mm] side space
- Drawers up to 18" [457 mm] wide
- Even lengths 16"–22" [406–559 mm]
- Steel ball bearings
- Clear zinc or black finish

## SPECIAL FEATURES

- Bracket mount/disconnect
- Easy disconnect for removal and work surface cleaning
- Lock-out secures slide in open position

## 301-2590

155-lb. [70 kg] load rating

Shelf or platform mounted pull-outs for pantries or entertainment centers.

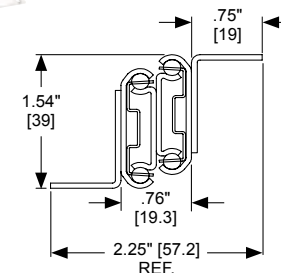
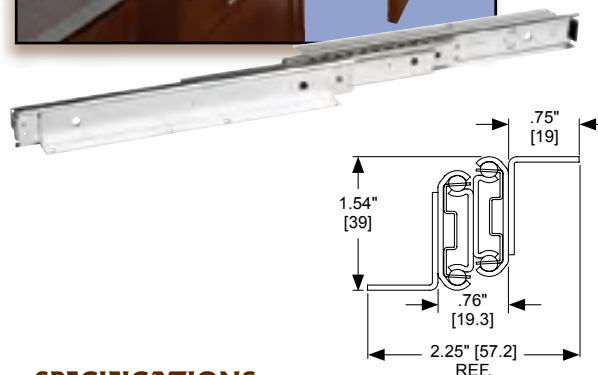

## SPECIFICATIONS

- .83" [21 mm] over travel
- 1.54" [39 mm] vertical space
- Drawers up to 16" [406 mm] wide
- Non-disconnect
- Steel ball bearings
- Even lengths 12"–28" [305–711 mm]
- Clear zinc or black finish

## SPECIAL FEATURES

- Mounts under shelves
- Hold-in detent to prevent drawer roll-out and bounce-back

3600-200/3600-201  
StowAway

175-lb. [80 kg] load rating

Keep waste containers and utility bins in kitchens, laundry or hobby rooms neatly out of sight.



3600-201 Shown

## SPECIFICATIONS

- Full extension
- Drawers up to 16" [406 mm] wide
- Standard 22" length [559 mm]
- Steel ball bearings
- Clear zinc finish

## SPECIAL FEATURES

- Self-closing action begins within 2-1/2" [63.5 mm] from cabinet opening
- Handed lever disconnect
- Attached brackets permit side, top or bottom mounting

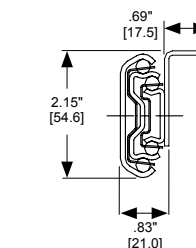

## 3600-200

- One fixed inboard bracket
- Outer member side-mounts directly onto cabinet wall

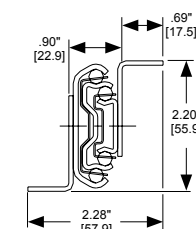

## 3600-201

- Inboard top bracket and outboard bottom bracket
- Slide may be mounted on top or bottom of the cabinet



## Limited Lifetime Warranty

Accuride International Inc. warrants its Accuride-branded drawer slides against defects in material and workmanship for so long as the original purchaser owns them.\* This warranty does not cover drawer slides which have been damaged due to abuse, improper installation, excessive loads, or any use contrary to the instructions accompanying the product. Accuride will send the original purchaser a replacement of the same model or a comparable model at no cost. This warranty is for replacement only and does not cover the cost of removal, installation, or incidental charges.

To obtain a replacement slide under this warranty, contact Accuride Technical Support within 30 days of the discovery of the defect. Please let us know how the product was used and the type of defect or malfunction experienced. Contact us by e-mail or phone at:

Technical@accuride.com  
or 562-903-0200, ext. 1436

The foregoing express limited warranty is in lieu of all other express warranties and excludes incidental or consequential damages. This warranty does not apply to products sold and used outside of the United States and Canada. All warranties implied by state law, including implied warranties of merchantability and fitness for a particular purpose, are expressly limited. Some states do not allow limitations on how long an implied warranty lasts or exclusion of incidental or consequential damages, so the foregoing limitation or exclusion may not apply to you. This Limited Lifetime Warranty gives you specific legal rights, and you may have other rights which vary from state to state.

\* This warranty does not apply to the cylinder for the Easy-Down® Flipper Door Slide®, CBERGO-TRAY Keyboard Systems, or any other Accuride product for which the expressed warranty differs from the Limited Lifetime Warranty offered above. Call Accuride Technical Support for further information.

**Accuride**

## What's new at Accuride

We've been über busy adding new things to our online line up! If you haven't been to [www.accuride.com](http://www.accuride.com) lately, stop by and check out our new features.

RSS

Share

Opt-in E-mail

Twitter

Facebook



RSS

No time to stop by the site to see what's new? Subscribe to our RSS feed and we'll send you a note when there's a new product launched or an important announcement. To sign up for the news that's of interest to you, subscribe when you are on your market's page. For example, if you are interested in cabinet hardware for wood products, click on the RSS icon when you are on a "wood" page.



SHARE

Find something cool you want to share with your boss, purchasing department, or poker buddies? Wherever you are on our site, when you click on the share button, you can share that page by email or with friends on your social network of choice, including sites such as Facebook, Twitter, or Delicious.



OPT-IN E-MAIL SUBSCRIPTION

Want to get on our mailing list? We'll never spam you—promise! We only send out announcements when we have a new product or special news to share.

TWITTER AND FACEBOOK

Yes, we've jumped on the social media bandwagon and we'd love to have you join us. We've set up market-specific pages so you can follow (and comment on!) the information that's most meaningful to you.

Here are the links:



Woodworking: <http://bit.ly/accurideww>  
Architectural: <http://bit.ly/accuridearch>



Woodworking: <http://twitter.com/accurideww>  
Architectural: <http://twitter.com/accuridearch>

See you online!

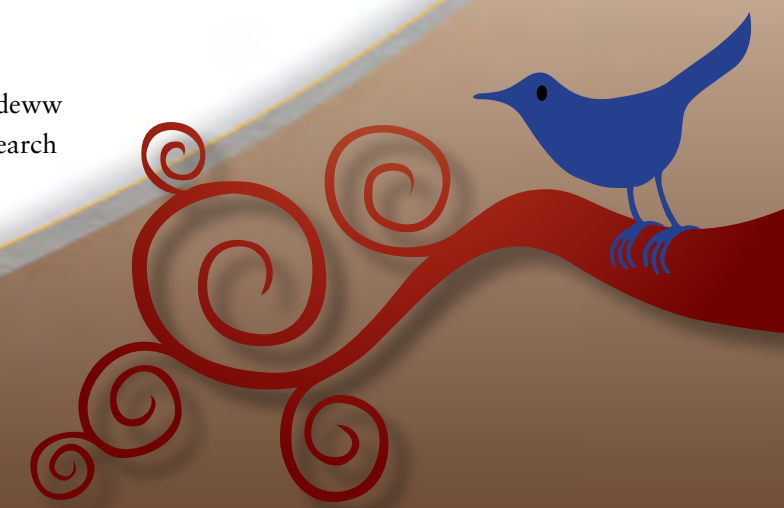





## ACCURIDE INTERNATIONAL INC.

### NORTH AMERICA

INTERNATIONAL HEADQUARTERS  
12311 Shoemaker Avenue  
Santa Fe Springs, California 90670  
562 903-0200 Telephone  
562 903-0208 Fax  
www accuride.com

Calle Circuito Norte No. 6  
Parque Industrial Nelson  
Mexicali, B.C., C.P. 21395 Mexico

### EUROPE

Postfach 1464  
Werner - Von Siemens - Strasse 16-18  
65582 Diez/Lahn  
Germany  
(49 64 32) 6 08-0 Telephone  
(49 64 32) 6 08-20 Fax  
www accuride-europe.com

Liliput Road  
Brackmills Industrial Estate  
Northampton, NN4 7AS  
United Kingdom  
(441) 604-761111 Telephone  
(441) 604-767190 Fax  
www accuride-europe.com

### ASIA

Accuride Japan Co., Ltd.  
44 Minami-asaji Iwata Yawata-shi  
Kyoto, Japan  
81-75-983-7500 Telephone  
81-75-983-9500 Fax  
www accuride.co.jp

Accuride International Suzhou Co. LTD  
No. 178, Suhong East Road  
Suzhou Industrial Park  
Jiangsu Province, China 215026  
86-512-62731200 Telephone  
86-512-62833993 Fax  
www accuride.com.cn

Follow us



DISTRIBUTED BY:

